



OPPORTUNITIES

ISSUE 11 VICTORVILLE, CALIFORNIA

SPRING
2011

OPPORTUNITIES IN THIS ISSUE

Your Business Here

Top Ten Fastest Growing Cities in the U.S.

Outlook SCLA

Air National Guard Builds New Hangar at SCLA

Retail Opportunities

Walmart Set to Construct Two New Stores in 2011

Local Vision

Leading Edge Aviation

Development Opportunities

Available Buildings at SCLA

Victorville's New Industrial Wastewater Treatment Facility is Operational

The City of Victorville completed construction on a new \$31 million industrial wastewater treatment facility in July 2010. The facility is located in the northwest portion of Southern California Logistics Airport (SCLA) and has been designed to provide services to large industrial users at the 5,000 acre industrial park.

The project was first envisioned when Dr Pepper Snapple Group approached the City looking for a site to build a manufacturing and distribution plant to serve the Western United States. Dr Pepper Snapple Group determined connection fees with wastewater suppliers in southern California to be cost-prohibitive. Capacity constraints were also a concern. The City then looked into ways to provide reliable wastewater services for Dr Pepper Snapple Group as well as other large industrial users in a cost-effective manner. Once the construction of a wastewater treatment plant at SCLA was possible, Dr Pepper Snapple committed to building an 850,000 square foot manufacturing and distribution center.

The new industrial wastewater treatment facility is owned and operated by the City and has been designed with an overall capacity of 2.5 million gallons per day. It includes anaerobic and aerobic wastewater treatment utilizing membrane bioreactor (MBR) technology and UV disinfection. The facility is ideal for food and beverage manufacturing operations and other manufacturing uses requiring high wastewater discharge. It also provides reclaimed water for a number of uses including landscape irrigation, golf course irrigation and for cooling towers at the High Desert Power Project at SCLA.



Victorville's New Industrial Wastewater Treatment Facility at Southern California Logistics Airport.



VICTORVILLE
California



Your Business Here

Top Ten Fastest Growing Cities in the U.S. – 100,000 or more in population

The City of Victorville was named the 6th fastest growing city in the United States by MSN Real Estate in October 2010. The southwestern U.S. dominated the top ten cities, with eight of the top ten slots. Victorville is the highest ranking city in California, with over 73% growth in population since 2000.

BUSINESS NEWS SUCCESS STORIES LOCAL DEMOGRAPHICS SERVICES REAL ESTATE

Outlook SCLA

Air National Guard Builds New Hangar at SCLA

In August 2010, The Air National Guard broke ground on a new hangar at Southern California Logistics Airport (SCLA). The multi-million dollar facility is the first ever Air National Guard hangar to be built specifically for Remotely Piloted Aircrafts (RPA). The California Air National Guard has been operating out of a temporary facility at SCLA conducting launches and recovery operations on the MQ-1 Predator. The Predator has been used extensively in Afghanistan and in other military actions overseas. Once complete, the new hangar will provide a custom space for the Predator and other RPAs.



The Air National Guard breaks ground on a new hangar at SCLA in Victorville.

Retail Opportunities

Walmart Set to Construct Two New Stores in 2011

As Victorville's population continues to grow, so does the demand for retail. Walmart, ranked as the world's largest public corporation based on revenue in 2010 by Forbes Magazine, recently confirmed plans for construction on two stores within the City of Victorville in the next year.

The new stores will be located in the expanding southern and western edges of the city. The southern location will be built at Dunia Plaza, a retail center that currently features Kohl's, Lane Bryant, Fashion Bug and Lowe's as well as established restaurant chains such as Mimi's Café and Chili's. Dunia Plaza is located just west of Interstate 15, near the Mall of Victor Valley and Restaurant Row areas.

Another Walmart center will be built on the western edge of Victorville, near an area that has seen tremendous residential expansion in the last five years. The new Walmart location will be on the northeast corner of Palmdale Road and Highway 395, with existing and new retail and restaurant pads flanking the new center. Both centers will serve the growing populations of Victorville and the Victor Valley region of over 350,000 people.

The floor plans at both locations include accommodations for retail as well as grocery sections within the stores. Groundbreaking on each store will take place in mid 2011 with construction planned throughout the year. Estimated openings for the new Walmart centers will be early 2012.

Top Ten Fastest Growing Cities in the U.S.

Population 100,000 or more

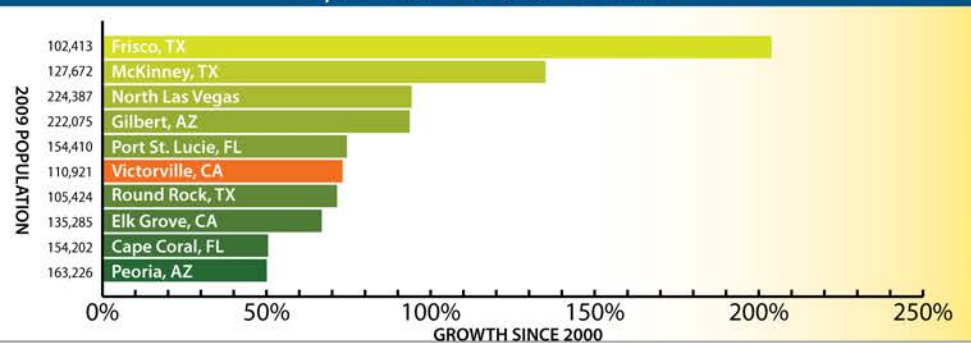

STATE BUSINESS NEWS SUCCESS STORIES



LOCAL VISION

Local Vision

Leading Edge Aviation

Leading Edge Aviation Services Flying High With Record Breaking Growth

Since 2007, Southern California Logistics Airport has been home to Leading Edge Aviation Services, the largest independent aircraft painting company in the world. Leading Edge services the private, commercial and military aviation industries, providing aircraft painting, aircraft interior restoration and fuel system maintenance services. The company also provides an array of services to the nation's largest aircraft modification and overhaul centers. Leading Edge has six facilities worldwide that service major carriers such as Delta, United/Continental, Southwest, Air Canada and United Parcel Service (UPS).

The company's Victorville site is comprised of a \$20 million hangar capable of storing a 747-size aircraft as well as a remodeled two-bay hangar that can store aircraft models as large as a 757. The site provides the company with great flexibility due to its size and proximity for clients in the Western United States. Victorville was an ideal location because it resides in a less restrictive air quality district than the rest of Southern California, the Mojave Desert Air Quality Management District (MDAQMD).

Despite the recent downturn in the economy, Leading Edge has never been busier. In 2010, Leading Edge experienced unprecedented growth, partly due to the recent mergers in the airline industry over the last few years. The most recent major airline merger of United and Continental in October 2010 prompted Leading Edge to double its workforce at the Victorville

facility to over 300 employees with even more hiring anticipated. Additional Leading Edge clients include Air France, Air India, Northwest Airlines as well as the United States Government.

"We are continuing to hire qualified applicants at the Victorville facility to meet the growing demand for aircraft painting" said Michael Manclark, Founder and CEO of Leading Edge Aviation Services. For the United and Continental merger, the company is responsible for stripping down and repainting most of the 700 planes to feature United's logo and Continental's design and colors. The project is expected to be complete by the end of 2012.

The company's Victorville site is comprised of a \$20 million hangar capable of storing a 747-size aircraft as well as a remodeled two-bay hangar that can store aircraft models as large as a 757.



Leading Edge Aviation Services success at SCLA has led to the company doubling its workforce in 2010 to over 300 employees.

Presort
Standard Rate
US Postage
PAID
Permit #007
Chico, CA



CITY OF VICTORVILLE
DEPARTMENT OF ECONOMIC DEVELOPMENT
14343 CIVIC DRIVE
VICTORVILLE, CA 92392

VICTORVILLE
California

UPCOMING EVENTS

- March 17, 2011** Small Business Day
Hilton Garden Inn, Victorville, CA
- April 30-May 4, 2011** Industrial Asset Management Council (IAMC)
Spring 2011 Professional Forum
Albuquerque, NM
- May 1-3, 2011**..... CoreNet Global Spring Summit, Chicago Midwest
Chicago, IL
- May 22-25, 2011** International Council of Shopping Centers (ICSC) ReCon
Las Vegas, NV

For more events information contact:

Tracy Foster • City of Victorville, Economic Development
(760) 241-6425 • tfoster@victorvillecity.com

Contact us at opportunities@victorvillecity.com to be removed from our mailing list.

DEVELOPMENT OPPORTUNITIES

Available Buildings at SCLA

Southern California Logistics Airport has several existing buildings available for immediate lease. Each building can be used for aviation manufacturing, or distribution use and offer additional office space. For more information on existing buildings at SCLA contact:

Collette Hanna, Business Development Manager
City of Victorville, Economic Development
(800) 780-1050
channa@ci.victorville.ca.us

Buildings at SCLA

Building 780

Size: 10,201 square feet
Usage: Warehouse and Manufacturing
Office space available: 5,782 square feet
Covered storage: 2,090 square feet

Building 789

Size: 15,570 square feet
Usage: Warehouse and Manufacturing
Office space available: 570 square feet
Covered storage: 570 square feet

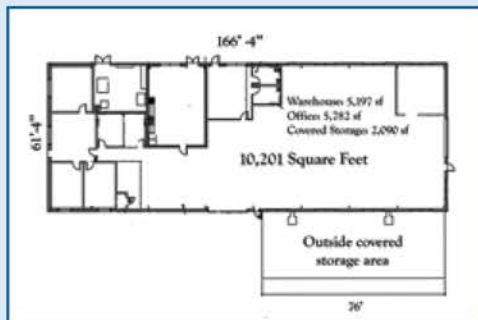

Bldg 780 Floor Plan



Bldg 789 Floor Plan